

# Concealed ceiling unit with medium ESP

Slimmest yet most powerful medium static pressure unit on the market

- › Slimmest unit in class, only 245mm (300mm built-in height) and therefore narrow ceiling voids are no longer a challenge
- › Low operation sound level down to 25dBA
- › Medium external static pressure up to 150Pa facilitates using flexible ducts of varying lengths
- › Possibility to change ESP via wired remote control allows optimisation of the supply air volume
- › Discretely concealed in the ceiling: only the suction and discharge grilles are visible
- › Multi zoning kit allows multiple individually-controlled climate zones to be served by one indoor unit
- › Optional fresh air intake
- › Flexible installation: air suction direction can be altered from rear to bottom suction and choice between free use or connection to optional suction grilles
- › Standard built-in drain pump with 625mm lift increases flexibility and installation speed

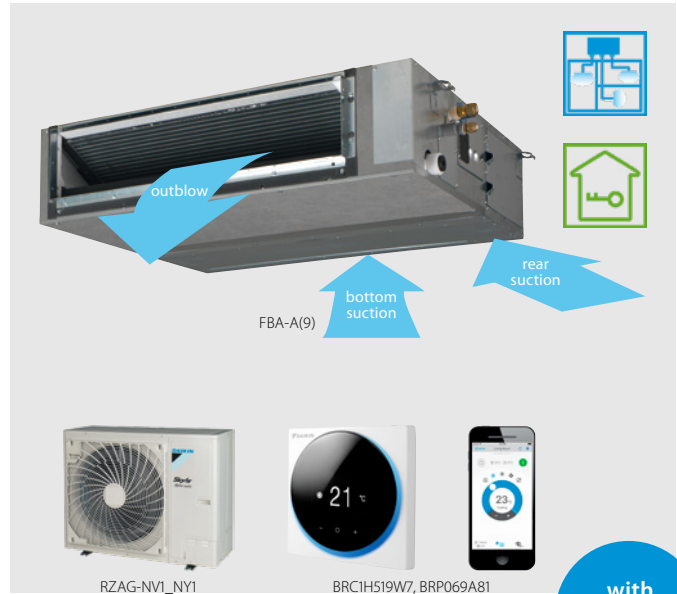

Efficiency data		FBA + RZAG	35A9 + 35A	50A9 + 50A	60A9 + 60A	71A9 + 71NV1	100A + 100NV1	125A + 125NV1	140A + 140NV1	71A9 + 71NY1	100A + 100NY1	125A + 125NY1	140A + 140NY1	
Cooling capacity	Min./Nom./Max.	kW	1.6/3.5/5.0	1.7/5.0/6.0	1.7/6.0/7.0	-/6.80/-	-/9.50/-	-/12.1/-	-/13.4/-	-/6.80/-	-/9.50/-	-/12.1/-	-/13.4/-	
Heating capacity	Min./Nom./Max.	kW	1.40/4.00/5.00	1.70/6.00/6.00	1.70/7.00/7.50	-/7.50/-	-/10.8/-	-/13.5/-	-/15.5/-	-/7.50/-	-/10.8/-	-/13.5/-	-/15.5/-	
Space cooling	Energy efficiency class		A++				-		A++					
	Capacity	Pdesign	kW	3.50	5.00	6.00	6.80	9.50	12.1	13.4	6.80	9.50	12.1	13.4
	SEER		6.12	6.30	6.15	6.22	6.47	6.19	6.42	6.22	6.47	6.19	6.42	
	ηs,c		%	-				245	254	-		245	254	
	Annual energy consumption		kWh/a	200	278	341	382	514	1,173	1,252	382	514	1,173	1,252
Space heating (Average climate)	Energy efficiency class		A+				-		A+					
	Capacity	Pdesign	kW	4.20	4.30	4.50	4.70	7.80	9.52		4.70	7.80	9.52	
	SCOP/A		4.10				4.20	4.36	4.12	4.11	4.20	4.36	4.12	4.11
	ηs,h		%	-				162	161	-		162	161	
	Annual energy consumption		kWh/a	1,434	1,469	1,537	1,566	2,505	3,235	3,243	1,566	2,505	3,235	3,243
<b>Indoor unit</b>		<b>FBA</b>	<b>35A9</b>	<b>50A9</b>	<b>60A9</b>	<b>71A9</b>	<b>100A</b>	<b>125A</b>	<b>140A</b>					
Dimensions	Unit	HeightxWidthxDepth	245x700x800			245x1,000x800			245x1,400x800					
Weight	Unit	kg	28.0			35.0			46.0					
Air filter	Type	Resin net												
Fan	Air flow rate	Cooling	Low/Medium/High		m³/min		10.5/12.5/15.0		12.5/15.0/18.0		23.0/26.0/29.0		23.5/29.0/34.0	
		Heating	Low/Medium/High		m³/min		10.5/12.5/15.0		12.5/15.0/18.0		23.0/26.0/29.0		23.5/29.0/34.0	
	External static pressure	Nom./High	Pa		30/150				40/150		50/150			
Sound power level	Cooling	dBA		60.0		56.0		58.0		62.0				
Sound pressure level	Cooling	Low/High	dBA		29.0/35.0		25.0/30.0		30.0/34.0		32.0/37.0			
	Heating	Low/High	dBA		29.0/37.0		25.0/31.0		30.0/36.0		32.0/38.0			
Control systems	Infrared remote control	BRC4C65 / BRC4C66												
	Wired remote control	BRC1H519W7/S7/K7 / BRC1E53A/B/C / BRC1D52												
Power supply	Phase/Frequency/Voltage	1~/50/60/220-240/220												
<b>Outdoor unit</b>		<b>RZAG</b>	<b>35A</b>	<b>50A</b>	<b>60A</b>	<b>71NV1</b>	<b>100NV1</b>	<b>125NV1</b>	<b>140NV1</b>	<b>71NY1</b>	<b>100NY1</b>	<b>125NY1</b>	<b>140NY1</b>	
Dimensions	Unit	HeightxWidthxDepth	734x870x373			870x1,100x460								
Weight	Unit	kg	52			81	85	95		81	85	94		
Sound power level	Cooling	dBA	62.0	63.0	64.0		66	69	70	64	66	69	70	
	Heating	dBA	62.0	63.0	64.0		-	68	71	-	68	71	71	
Sound pressure level	Cooling	Nom.	dBA	48.0	49.0	50.0	46	47	49	50	46	47	49	50
	Heating	Nom.	dBA	48.0	49.0	50.0	48	50	52		48	50	52	
Operation range	Cooling	Ambient	Min.~Max.	°CDB				-20~52						
	Heating	Ambient	Min.~Max.	°CWB				-20~18						
Refrigerant	Type/GWP	R-32/675.0												
	Charge	kg/TCO2Eq	1.55/1.05		3.20/2.16		3.70/2.50		3.20/2.16		3.70/2.50			
Piping connections	Liquid/Gas	OD	mm		64/9.50		64/12.7		952/15.9					
	Piping length	OU - IU	Max.	m		55		85		55		85		
		System	Equivalent	m		-		75		100		75		100
		Chargeless	m		-		40							
	Additional refrigerant charge		kg/m	0.02 (for piping length exceeding 30m)										
	Level difference	IU - OU	Max.	m		30.0								
Power supply	Phase/Frequency/Voltage	Hz/V												
Current - 50Hz	Maximum fuse amps (MFA)	A	16		20		32		16					

# Concealed ceiling unit with medium ESP

Slimmest yet most powerful medium static pressure unit on the market

- > Combination with Sky Air advance-series ensures good value for money for all types of commercial applications
- > Slimmest unit in class, only 245mm (300mm built-in height) and therefore narrow ceiling voids are no longer a challenge
- > Low operation sound level down to 25dBA
- > Medium external static pressure up to 150Pa facilitates using flexible ducts of varying lengths
- > Possibility to change ESP via wired remote control allows optimisation of the supply air volume



## Optimised supply air volume

Automatically selects the most appropriate fan curve to achieve the units' nominal air flow within ±10%

### Why?

After installation the real ducting will frequently differ from the initially calculated air flow resistance → the real air flow may be much lower or higher than nominal, leading to a lack of capacity or uncomfortable air temperature. Automatic Airflow Adjustment function will adapt the unit's fan speed to any ducting automatically (10 or more fan curves are available on every model), making installation much faster

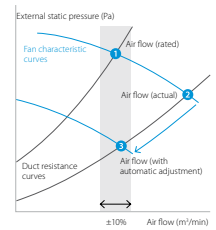

Efficiency data		FBA + RZASG	71A9 + 71MV1	100A + 100MV1	125A + 125MV1	140A + 140MV1	100A + 100MY1	125A + 125MY1	140A + 140MY1	
Cooling capacity	Nom.	kW	6.80	9.50	12.1	13.4	9.50	12.1	13.4	
Heating capacity	Nom.	kW	7.50	10.8	13.5	15.5	10.8	13.5	15.5	
Space cooling	Energy efficiency class		A++	A+			A+			
	Capacity	Pdesign	kW	6.80	9.50	12.1	13.4	9.50	13.4	
	SEER		6.19	5.83	5.49	5.81	5.83	5.49	5.81	
	ηs,c		%	-	-	217	229	-	217	229
	Annual energy consumption		kWh/a	385	570	1,322	1,384	570	1,322	1,384
Space heating (Average climate)	Energy efficiency class		A+	A			A			
	Capacity	Pdesign	kW	4.50		6.00		6.00		7.80
	SCOP/A		4.01		3.85		3.85		3.63	3.85
	ηs,h		%	-	-	142	151	-	142	151
	Annual energy consumption		kWh/a	1,571	2,182	2,314	2,836	2,182	2,314	2,836

Indoor unit		FBA	71A9	100A	125A	140A	100A	125A	140A
Dimensions	Unit	HeightxWidthxDepth	mm	245x1,000x800					
Weight	Unit		kg	35.0					
Air filter	Type		Resin net						
Fan	Air flow rate	Cooling	Low/Medium/High	m³/min	12.5/15.0/18.0	23.0/26.0/29.0	23.5/29.0/34.0	23.0/26.0/29.0	23.5/29.0/34.0
		Heating	Low/Medium/High	m³/min	12.5/15.0/18.0	23.0/26.0/29.0	23.5/29.0/34.0	23.0/26.0/29.0	23.5/29.0/34.0
	External static pressure	Nom./High	Pa	30/150	40/150	50/150	40/150	50/150	
Sound power level	Cooling		dBA	56.0	58.0	62.0	58.0	62.0	
Sound pressure level	Cooling	Low/High	dBA	25.0/30.0	30.0/34.0	32.0/37.0	30.0/34.0	32.0/37.0	
	Heating	Low/High	dBA	25.0/31.0	30.0/36.0	32.0/38.0	30.0/36.0	32.0/38.0	
Control systems	Infrared remote control		BRC4C65 / BRC4C66						
	Wired remote control		BRC1H519W7/S7/K7 / BRC1E53A/B/C / BRC1D52						
Power supply	Phase/Frequency/Voltage	Hz/V	1~/50/60/220-240/220						

Outdoor unit		RZASG/RZASG	71MV1	100MV1	125MV1	140MV1	100MY1	125MY1	140MY1
Dimensions	Unit	HeightxWidthxDepth	mm	770x900x320					
Weight	Unit		kg	60	70	78	70	77	
Sound power level	Cooling		dBA	65	70	71	70	71	73
	Heating		dBA	-	71	73	-	71	73
Sound pressure level	Cooling	Nom.	dBA	46	53	54	53	54	
	Heating	Nom.	dBA	47		57			
Operation range	Cooling	Ambient	Min.~Max.	-15~-46					
	Heating	Ambient	Min.~Max.	-15~-15.5					
Refrigerant	Type/GWP		R-32/675						
Piping connections	Charge		kg/CO2Eq	2.45/1.65	2.60/1.76	2.90/1.96	2.60/1.76	2.90/1.96	
	Liquid/Gas	OD	mm	9.52/15.9					
	Piping length	OU - IU	Max.	m					
	System	Equivalent	Chargeless	m					
	Additional refrigerant charge		kg/m	See installation manual					
Power supply	Level difference	IU - OU	Max.	m					
	Phase/Frequency/Voltage	Hz/V	1~/50/220-240						
Current - 50Hz	Maximum fuse amps (MFA)	A	20	25	32		16		

# Concealed ceiling unit with medium ESP

Slimmest yet most powerful medium static pressure unit on the market

- › Ideal solution for small businesses and shops
- › Slimmest unit in class, only 245mm (300mm built-in height) and therefore narrow ceiling voids are no longer a challenge
- › Low operation sound level down to 25dBA
- › Medium external static pressure up to 150Pa facilitates using flexible ducts of varying lengths
- › Possibility to change ESP via wired remote control allows optimisation of the supply air volume
- › Discretely concealed in the ceiling: only the suction and discharge grilles are visible
- › Multi zoning kit allows multiple individually-controlled climate zones to be served by one indoor unit
- › Reduced energy consumption thanks to specially developed DC fan motor
- › Optional fresh air intake
- › Flexible installation: air suction direction can be altered from rear to bottom suction and choice between free use or connection to optional suction grilles
- › Standard built-in drain pump with 625mm lift increases flexibility and installation speed



Efficiency data		FBA	71A9 / ARXM71N9	100A + AZAS100MV1	125A + AZAS125MV1	140A + AZAS140MV1	100A + AZAS-100MY1	125A + AZAS-125MY1	140A + AZAS-140MY1	
Cooling capacity	Nom.	kW	6.80	9.50	12.1	13.4	9.50	12.1	13.4	
Heating capacity	Nom.	kW	7.50	10.8	13.5	15.5	10.8	13.5	15.5	
Space cooling	Energy efficiency class		A		-		A		-	
	Capacity	Pdesign	kW	6.80	9.50	12.1	13.0	9.50	12.1	13.0
	SEER			5.57	5.25	4.85	5.50	5.25	4.85	5.50
	ηs,c		%	-	-	191	217	-	191	217
	Annual energy consumption		kWh/a	427	633	1,497	1,418	633	1,497	1,418
Space heating (Average climate)	Energy efficiency class		A		-		A		-	
	Capacity	Pdesign	kW	4.50	6.00	7.80	6.00	6.00	7.80	
	SCOP/A			3.81		3.55	3.85	3.81	3.55	3.85
	ηs,h		%	-	-	139	151	-	139	151
	Annual energy consumption		kWh/a	1,652	2,205	2,366	2,836	2,205	2,366	2,836
Indoor unit		FBA	71A9	100A	125A	140A	100A	125A	140A	
Dimensions	Unit	HeightxWidthxDepth	mm	245x1,000x800		245x1,400x800				
Weight	Unit		kg	35.0		46.0				
Air filter	Type			Resin net						
Fan	Air flow rate	Cooling	Low/Medium/High	m³/min	12.5/15.0/18.0	23.0/26.0/29.0	23.5/29.0/34.0	23.0/26.0/29.0	23.5/29.0/34.0	
		Heating	Low/Medium/High	m³/min	12.5/15.0/18.0	23.0/26.0/29.0	23.5/29.0/34.0	23.0/26.0/29.0	23.5/29.0/34.0	
	External static pressure	Nom./High		Pa	30/150	40/150	50/150	40/150	50/150	
Sound power level	Cooling			dBA	56.0	58.0	62.0	58.0	62.0	
Sound pressure level	Cooling	Low/High		dBA	25.0/30.0	30.0/34.0	32.0/37.0	30.0/34.0	32.0/37.0	
	Heating	Low/High		dBA	25.0/31.0	30.0/36.0	32.0/38.0	30.0/36.0	32.0/38.0	
Control systems	Infrared remote control			BRC4C65 / BRC4C66						
	Wired remote control			BRC1H519W7/S7/K7 / BRC1E53A/B/C / BRC1D52						
Power supply	Phase/Frequency/Voltage			Hz/V						
				1~/50/60/220-240/220						
Outdoor unit		ARXM71N9	AZAS100MV1	AZAS125MV1	AZAS140MV1	AZAS100MY1	AZAS125MY1	AZAS140MY1		
Dimensions	Unit	HeightxWidthxDepth	mm	734x870x373		990x940x320				
Weight	Unit		kg	50.0	70	78	70	77		
Sound power level	Cooling			dBA	65	70	71	73		
	Heating			dBA	65	-	71	73		
Sound pressure level	Cooling	Nom.		dBA	52	53	54	53		
	Heating	Nom.		dBA	52		57			
Operation range	Cooling	Ambient	Min.~Max.	°CDB	-10~-46		-5~-46			
	Heating	Ambient	Min.~Max.	°CWB	-15~-18		-15~-15.5			
Refrigerant	Type/GWP			R-32/675						
	Charge		kg/CO2Eq	1.15/0.78	2.60/1.76	2.90/1.96	2.60/1.76	2.90/1.96		
Piping connections	Liquid/Gas	OD	mm	9.52/15.9						
	Piping length	OU - IU	Max.	m	30					
		System	Equivalent	m	50					
			Chargeless	m	30					
		Additional refrigerant charge		kg/m	0.035 (for piping length exceeding 10m)					
	Level difference	IU - OU	Max.	m	20					
Power supply	Phase/Frequency/Voltage			Hz/V			3~/50/380-415			
Current - 50Hz	Maximum fuse amps (MFA)		A	-	25	32		16		

# Concealed ceiling unit with medium ESP

Slimmest yet most powerful medium static pressure unit on the market

- > Combination with split outdoor units is ideal for small retail, offices and residential applications
- > Slimmest unit in class, only 245mm (300mm built-in height) and therefore narrow ceiling voids are no longer a challenge
- > Low operation sound level down to 25dBA
- > Medium external static pressure up to 150Pa facilitates using flexible ducts of varying lengths
- > Possibility to change ESP via wired remote control allows optimisation of the supply air volume



## Optimised supply air volume

Automatically selects the most appropriate fan curve to achieve the units' nominal air flow within ±10%

### Why?

After installation the real ducting will frequently differ from the initially calculated air flow resistance → the real air flow may be much lower or higher than nominal, leading to a lack of capacity or uncomfortable air temperature. Automatic Airflow Adjustment function will adapt the unit's fan speed to any ducting automatically (10 or more fan curves are available on every model), making installation much faster

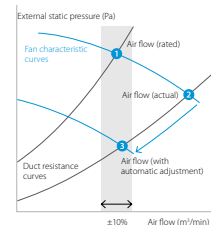

Efficiency data		FBA + RXM	35A9 + 35N9	50A9 + 50N9	60A9 + 60N9
Cooling capacity	Nom.	kW	3.40	5.00	5.70
Heating capacity	Nom.	kW	4.00	5.50	7.00
Space cooling	Energy efficiency class		A++		
	Capacity	Pdesign kW	3.40	5.00	5.70
	SEER		6.23	6.27	5.91
	ηs,c	%	-	-	-
Space heating (Average climate)	Annual energy consumption	kWh/a	191	279	337
	Energy efficiency class		A+		
	Capacity	Pdesign kW	2.90	4.40	4.60
	SCOP/A		4.07	4.06	4.01
	ηs,h	%	-	-	-
Annual energy consumption	kWh/a	996	1,517	1,607	

Indoor unit		FBA	35A9	50A9	60A9
Dimensions	Unit HeightxWidthxDepth	mm	245x700x800		245x1,000x800
Weight	Unit	kg	28.0		35.0
Air filter	Type		Resin net		
Fan	Air flow rate	Cooling Low/Medium/High	10.5/12.5/15.0		12.5/15.0/18.0
		Heating Low/Medium/High	10.5/12.5/15.0		12.5/15.0/18.0
	External static pressure	Nom./High	30/150		
Sound power level	Cooling	dB(A)	60.0		56.0
Sound pressure level	Cooling	Low/High	29.0/35.0		25.0/30.0
	Heating	Low/High	29.0/37.0		25.0/31.0
Control systems	Infrared remote control		BRC4C65 / BRC4C66		
	Wired remote control		BRC1H519W7/S7/K7 / BRC1E53A/B/C / BRC1D52		
Power supply	Phase/Frequency/Voltage	Hz/V	1~/50/60/220-240/220		

Outdoor unit		RXM	35N9	50N9	60N9
Dimensions	Unit HeightxWidthxDepth	mm	550x765x285	734x870x373	
Weight	Unit	kg	32	50	
Sound power level	Cooling	dB(A)	61	62	63
	Heating	dB(A)	61	62	63
Sound pressure level	Cooling	Nom.	49	48	
	Heating	Nom.	49	48	
Operation range	Cooling	Ambient Min.~Max.	-10~-50		
	Heating	Ambient Min.~Max.	-20~24		
Refrigerant	Type		R-32		
	GWP		675		
	Charge	kg/CO2Eq	0.76/0.52		1.15/0.78
Piping connections	Liquid	OD	6.35		
	Gas	OD	9.52	12.7	
	Piping length	OU - IU Max. System Chargeless	20	30	
			10	-	
	Additional refrigerant charge	kg/m	0.02 (for piping length exceeding 10m)		
Power supply	Phase/Frequency/Voltage	Hz/V	1~/50/220-240		
Current - 50Hz	Maximum fuse amps (MFA)	A	-		